



SD35 User Guide

Appearance



Keypad



Virtual Keyboard

When the device is turned for the first time ,please Click “Setting”
 -> ”system ”->”Languages&Input”->”Physical Keyboard”,and enable “Show
 Virtual keyboard”.Then you can use “Virtual Keyboard”and”Physical Keyboard”
 at the same time.

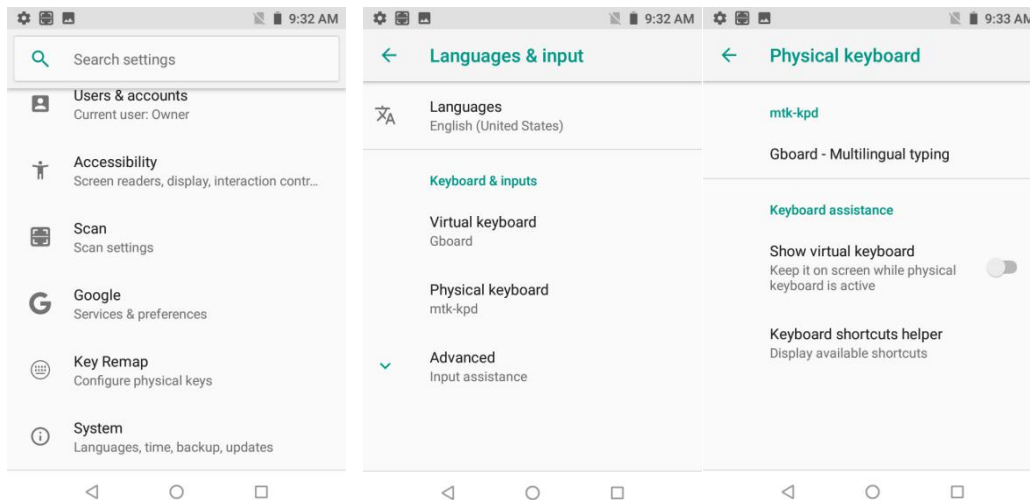

Quick setup

You can click the iron in the lower right corner to enter the “Change keyboard”
 interface to enable “Show virtual keyboard”.

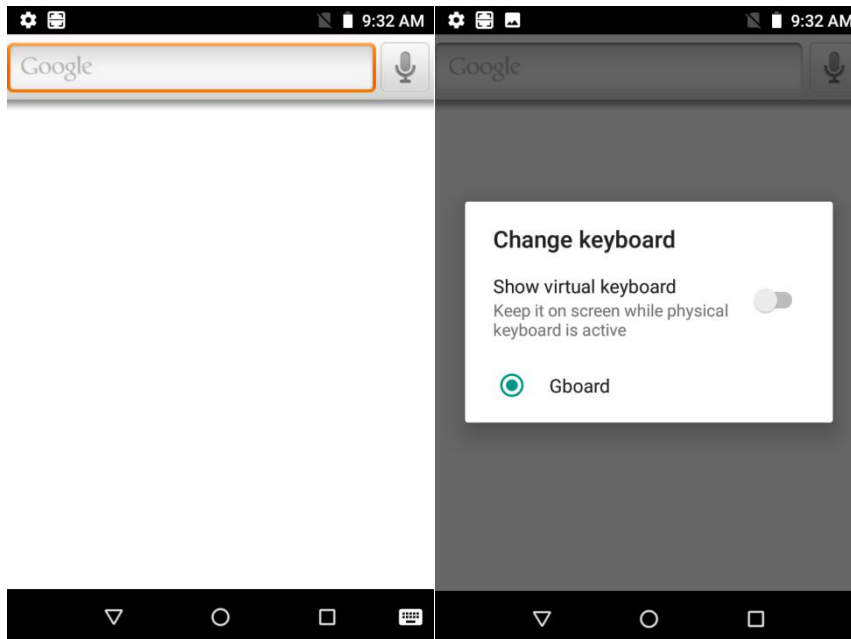

Click “Setting”->”system”->”Languages&Input”-”Virtual Keyboard”,then click
 “manage keyboard”,you can manage the virtual keyboard.

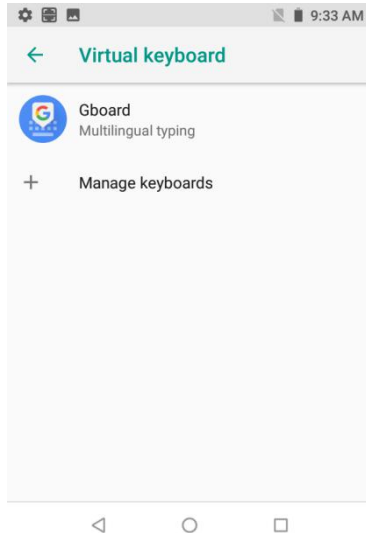

Physical Keyboard

When the device is turned on for the first time, the default input of the physical keyboard is numbers. You can switch between numbers and uppercase and lowercase by pressing the “aA” key.



Note: Please refer to the “physical key definition” for how to use the function keys.

SIM Card

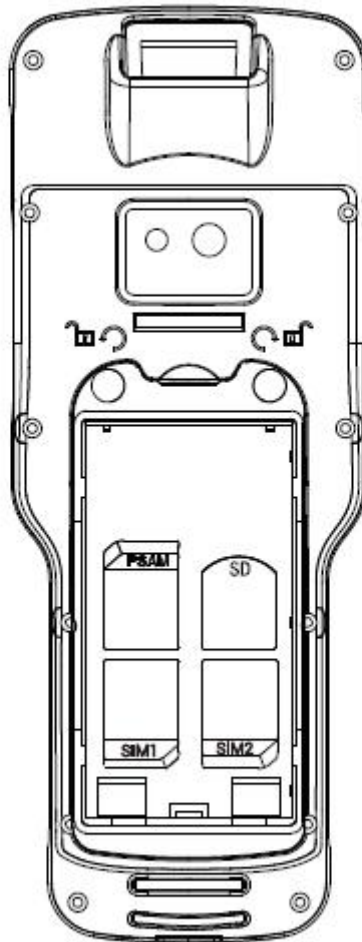

- 1 Both SIM cards use standard Nano-SIM cards. Please use professional equipment to open the SIM card warehouse, so as not to damage the equipment and affect the protection performance.
- 2 When the SIM1 card is placed, the SIM1 card is placed horizontally in the upper right corner of the second layer of the slot, which is flat with the slot, and the SIM1 card is successfully placed.
- 3 When the SIM2 card is placed, the SIM2 card is placed horizontally in the upper left corner of the first layer of the slot, which is flat with the slot, and the SIM2 card is successfully placed.
- 4 Memory card slot, maximum expandable 128G memory card.

Charging&Attention

1 Please use the supplied charger and USB (Type-C) cable. Otherwise, the fast charging mode cannot be enabled. Using a non-original charger and a USB charging cable may result in long charging time and repeated restarts, and affect the battery life.

2 It is recommended not to operate the devices while charging, and not to cover objects on the device and charger.

3 When the device is in low power, there will be an indicator light and a desktop pop-up reminder. Please charge as soon as possible to avoid affecting normal use.

4 Please ensure that the power is about 50% when store the equipment for a long time. Please place the equipment in a suitable environment with dry temperature to avoid equipment failure caused by long-term storage.

5 In case of damage to the battery, charging head and charging cable, please contact us in time to purchase, do not repair it yourself, so as to avoid danger and cause extra loss.

Charging indicator status

Device charging indicator

Red light blinking:low-battery.

Red light on:charging in process.

Green light on:fully charged.

Cradle indicator status

Red light on:extra-battery charging in process.

Green light on:extra-battery fully charged.

Power on&Power off&Restart

1 When the device is powered off, press and hold the power button for 2 seconds. And the device will boot into the Android operating system. It takes a long time to initialize the device. Please wait patiently.

2 When the device is powered on, press and hold the power button for 2 seconds. The system will pop-up menu and display two options: "Power off", and "Restart". Choose "Power off" or "Restart".

3 When the device is abnormal or unable to operate, press and hold the red power button for more than 15 seconds to force restart the device.

Locking and Unlocking the device

Lock the device: Brief press the power button on the right side of device, if no operation is performed on the device for a preset period of time, the device will lock automatically. You can change how long it takes the device lock.

Unlock the device: Brief press the power button on the right side of device and slide the screen upward. If no screen method is set, you can directly enter the system interface. If the screen method is set, you need to enter an unlock password or pattern to enter.

Unlocking method settings: settings->Security&location->Screen lock, Choose the unlock method you need.

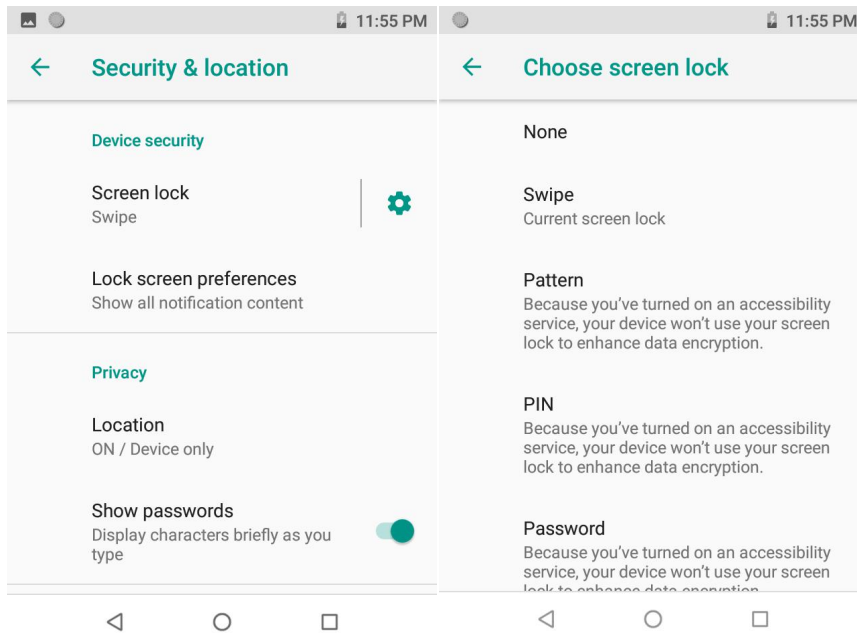

Note: If you select "pattern Unlock", please pay attention to the prompts during setting, whether you want to use the pattern to unlock when you turn on the device, select "Yes", you need to use the pattern you set to unlock after restarting the device.

***If you accidentally forget the unlock pattern or password, please contact us. ***

Home Screen

Swipe up anywhere on the main screen to enter the application drawer to view all applications.

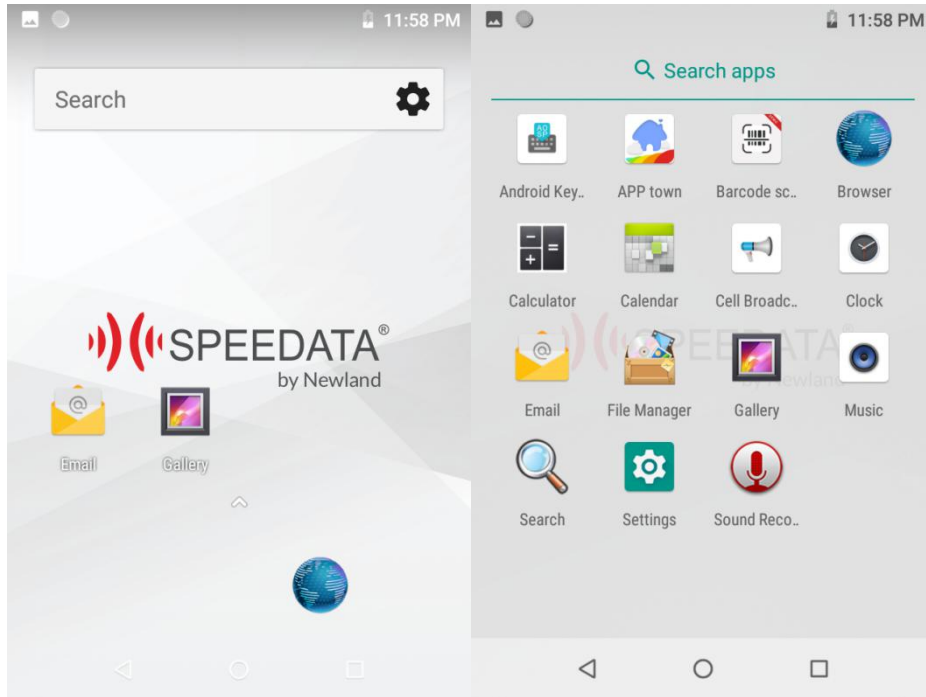

Open an app: Tap to open an app.

Add an app icon to the home screen: Swipe up on the main screen interface to see all applications. Tap and hold your desired app and then drag it on the home screen.

Installing App: Use one of the following methods to install a new app on the device.

1 Download an APK file from APP town, and install it. (Only the programs uploaded by us, the overseas version may not have this in the future, so it is not recommended.)

2 Install third-party app stores yourself.

3 Connect device to PC with the supplied cable. The computer transfers the application installation package to the device, then the device opens the file manager to find the installation package and install it. (Note that the file suffix is .apk, it can be installed directly.)

Uninstalling APP: Long press your desired APP icon, click "App info" to enter the app info, then click uninstall.

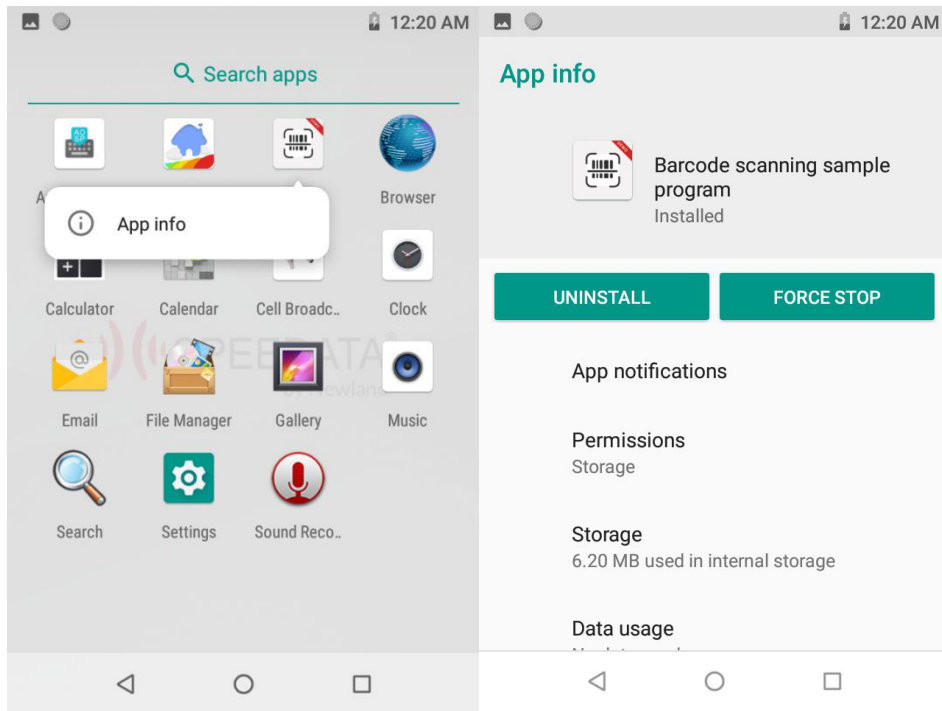

Notification bar

Touch the top of the screen and swipe down to open the notification bar. You can click the shortcut function icons to turn on and off the corresponding functions such as WLAN, Bluetooth, etc. Unprocessed notification items can be double-tap to expand, touch to view, or swipe left and right to remove.

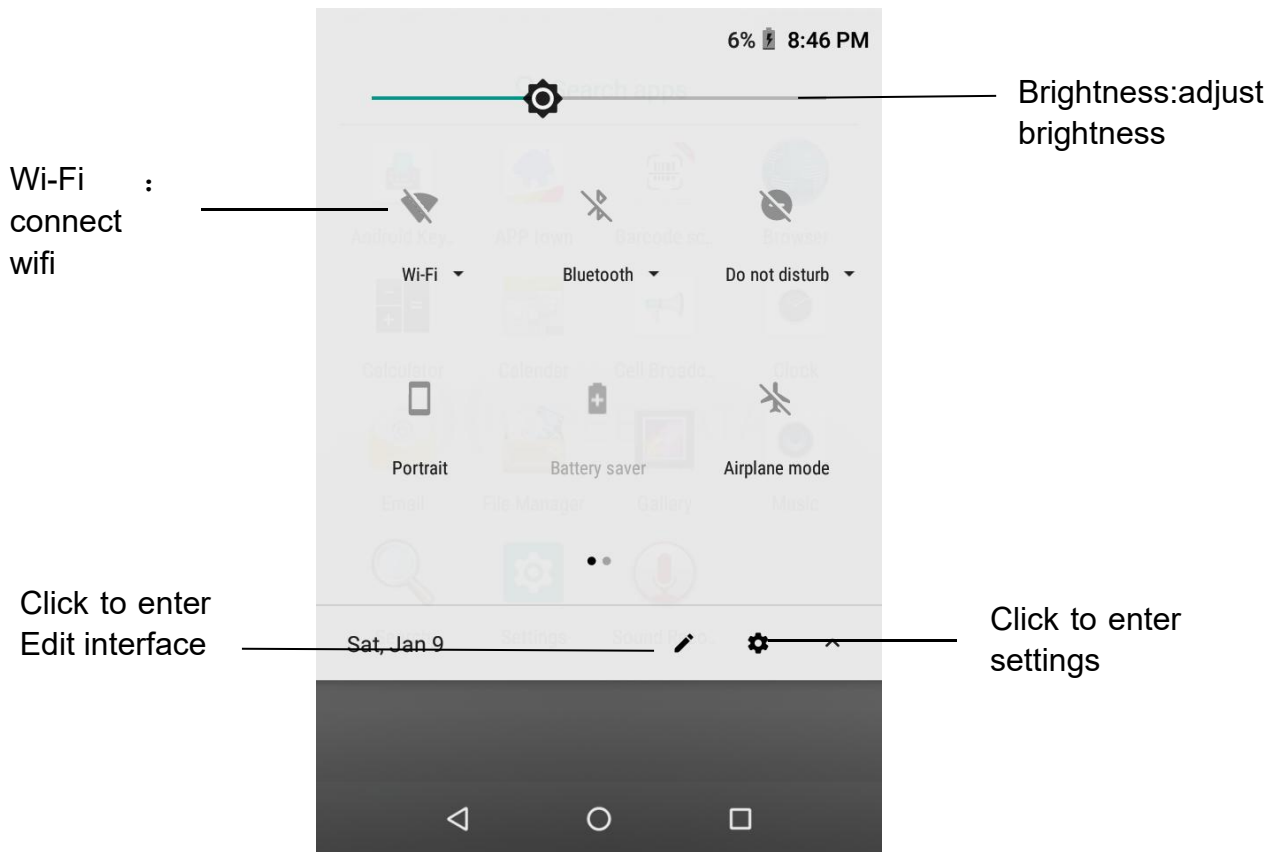

Communicating with PC

- 1 Connect the USB port on the SD35 to your computer with included USB cable.
- 2 Switch the device on,touch the top of the screen and swipe down to open the notification bar as show below.
- 3 Tap "USB charging this device",Then tap for more options.Then you may handle the files on the terminal though your computer.

USB debugging connected:connect USB to disable USB debugging mode

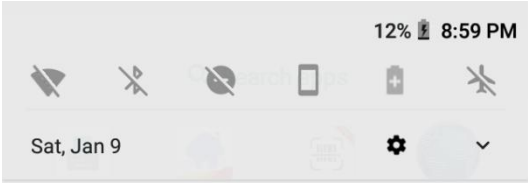

Notification bar:double-tap to expand,touch to view,swipe left and right to remove

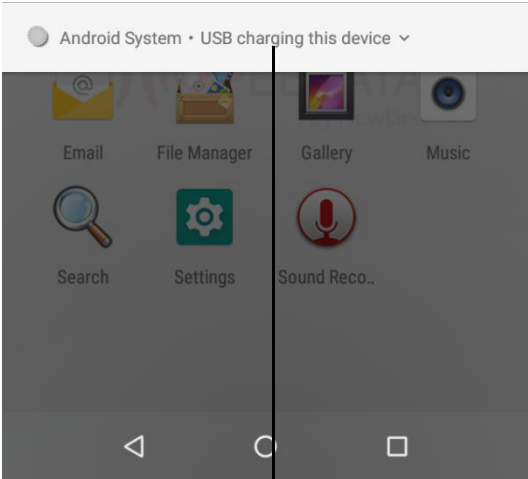

USB usage:Click to enter the USB usage selection interface, select the corresponding mode according to your needs

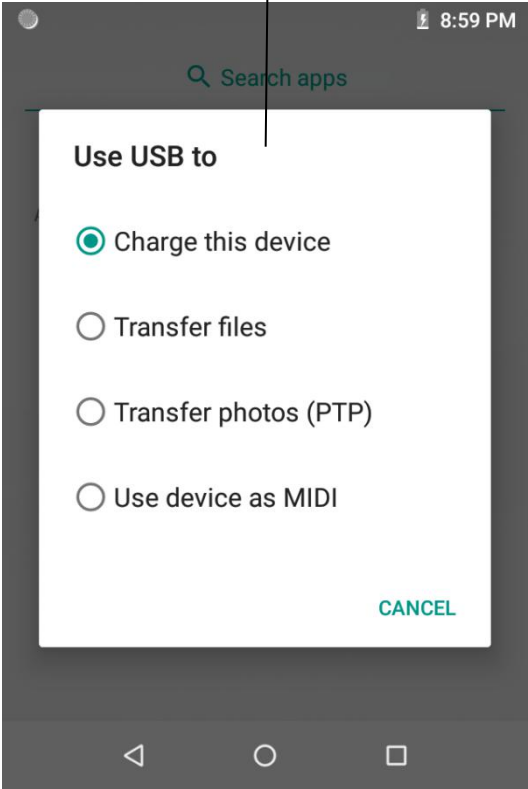

Screenshot

Press the device "power" and "volume-" buttons at the same time to take a screenshot, or swipe down the screen to open the notification bar, and click the screenshot icon to take a screenshot.

Date&time

Set the Date&time:Click Settings->System->Date&time.The time provided by the network can be set as needed or the time zone can be set manually.

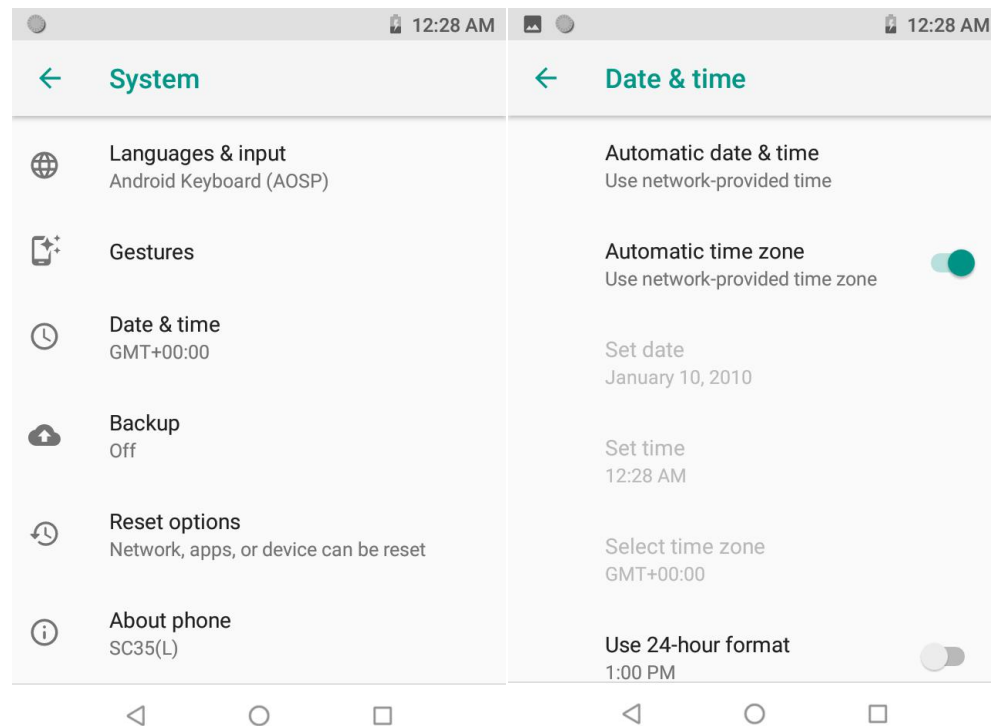

Display

Click settings->Display,Set the screen brightness, wallpaper, font size etc. according to your needs.

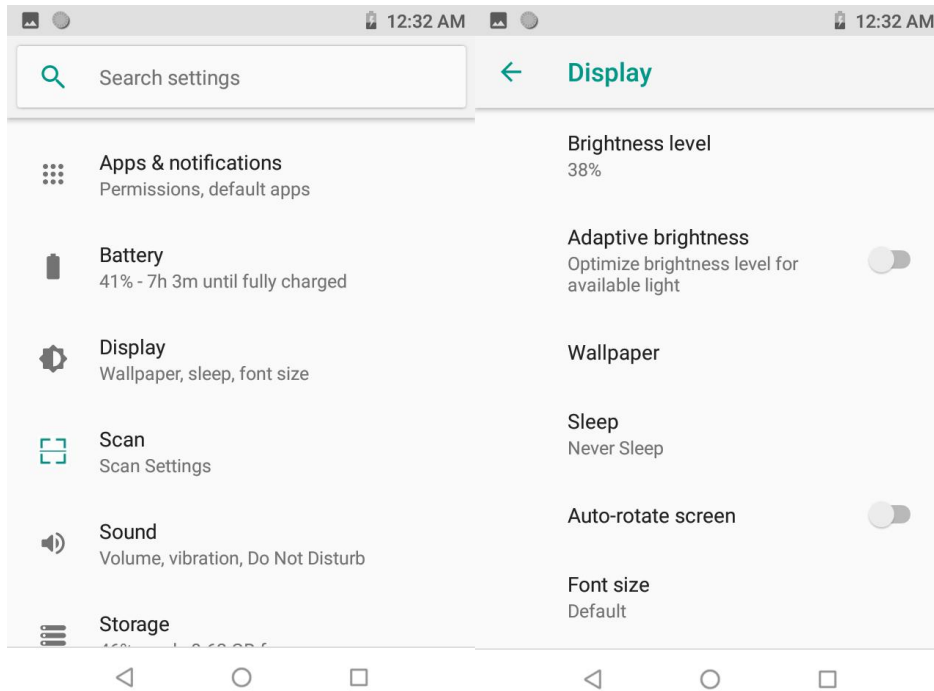

Sound

Click settings->Sound, you can set the volume, call vibration, mobile phone ringtone, etc. according to your needs.

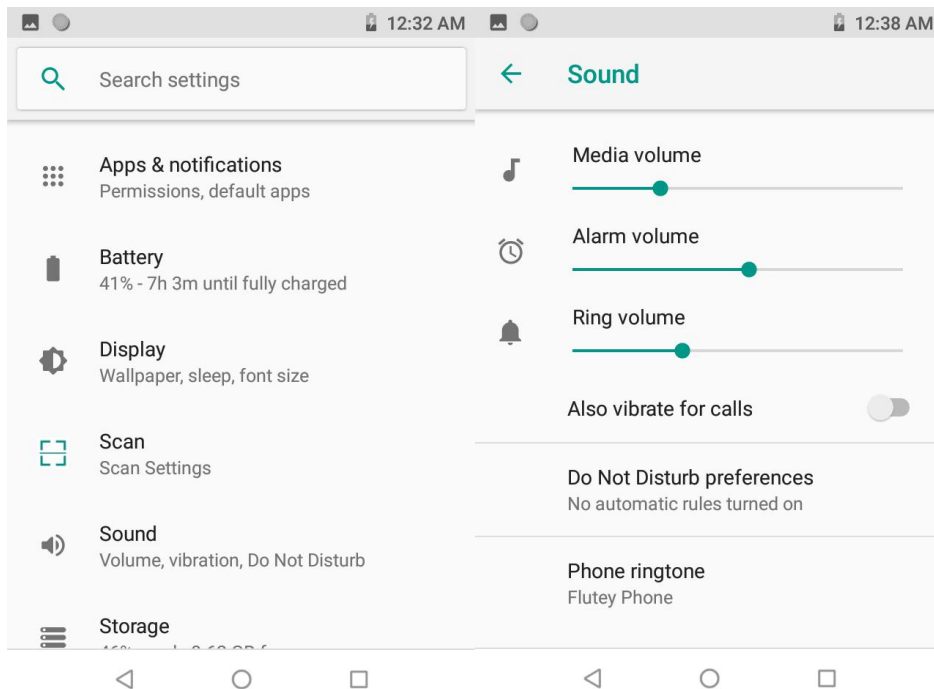

Note: There is no sound during the use of the device, you can enter the ringtone setting, check whether the volume setting is too low, and check whether the "Do Not Disturb preferences" is turned on by mistake.

WIFI & Network



Connect to a Wi-Fi network

- 1 Swipe down from the status bar to open the notification panel.
- 2 Press  to enter the WLAN settings interface.
- 3 Turn on the WLAN switch. The system will list the detected WLAN networks in tabular form.
- 4 Click on the WLAN network to connect. If you have selected an encrypted network, you need to enter an access password connection.

Connect mobile data networks

- 1 Swipe down from the status bar to open the notification panel.
- 2 Click  to open mobile data network.
- 3 When you do not use a mobile network, please turn off the mobile data service in time to save data traffic and extend standby time.

Change default language

- 1 The default display language of the system is English. After the factory settings or firmware upgrade, the system display language is restored to English.
- 2 Click  Settings, Click System > Languages & input > Languages > + Add a language, Select the language you want to add. Drag , drag the language you want to change to the top, and the change is complete.

Barcode Scanning

Basic Settings

Click "Settings"- "Scan" to enter the scan settings.

Scan engine on/off: Turn on / off the barcode scanning function.

Out to Cursor: Results of scanned barcode displayed at focus.

Scan Sound: After the barcode scanning is finished, the tone will sound.

Scan Vibrate: Vibration alert after barcode scanning.

Save Image: Save the barcode picture to album.

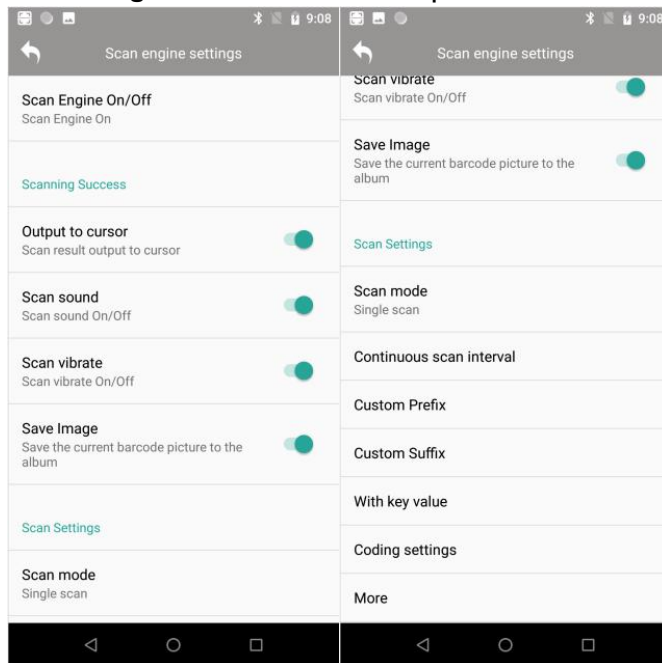

Scan mode: The device has a built-in three-minute scan mode. Select the fast scan mode you are used to. It needs to be turned on and off to enable the scan.

A, Long-press continuous scan: In this mode, press and hold the scan button to turn on the scan laser, release it to automatically turn off the scan laser, and if the barcode is successfully scanned when the scan button is pressed, the scan laser is turned on repeatedly.

B, Single scan: In this mode, press the scan button to turn on the scan laser. If a barcode is successfully scanned, the scan laser will automatically turn off. If no barcode is scanned within 10 seconds, the scan laser will automatically turn off, or press the scan button 1 second, the release laser is automatically turned off.

C, One-click continuous scan: In this mode, press the scan button to turn on the scanning laser. After the barcode is successfully scanned, the scanning light will not turn off, and continuous scanning will be excited. Press the scan button again to turn off the scanning laser.

Continuous Scan Interval: Setting the continuous Scan Interval(ms).

Attached key value: Special keys are added after the barcode output, such as

"Enter" and "Line Feed".

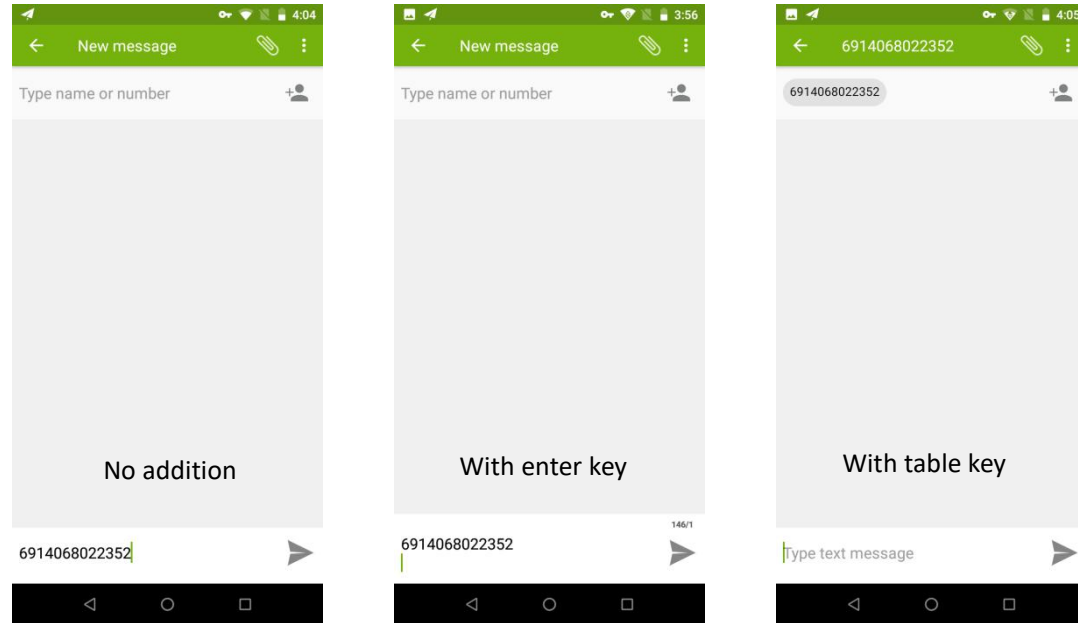

Add custom prefix: add custom characters, numbers, letters, etc. before the barcode output (add "#" for demonstration)

Add a custom suffix: add custom characters, numbers, letters, etc. after the barcode output (add "#" for demonstration)

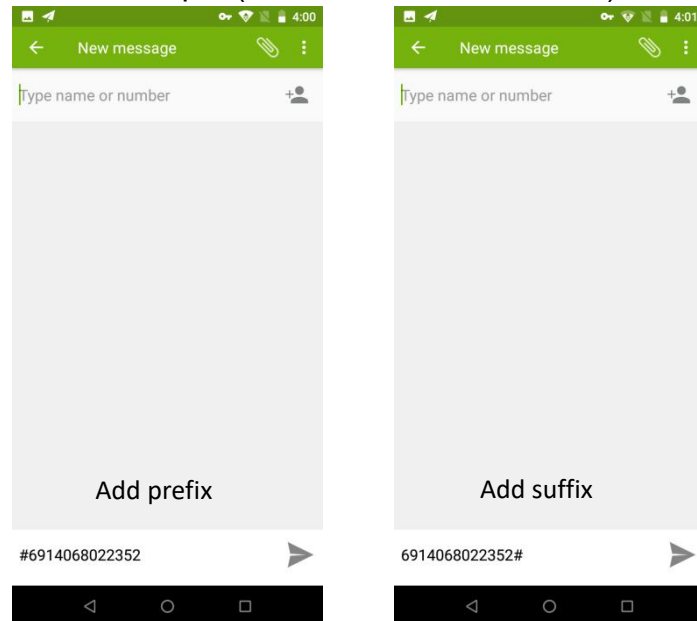

Code setting: Configure the barcode parameters of one-dimensional and two-dimensional code.

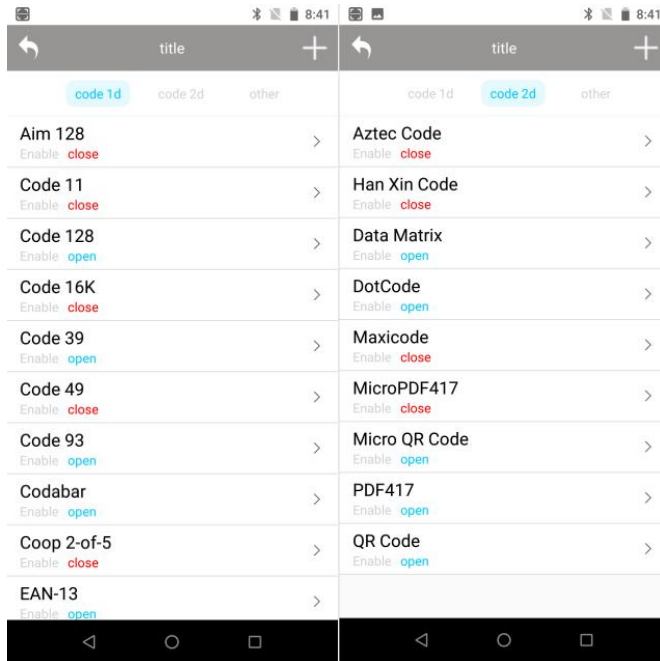

Choose code-1d-EAN-13-Enable

such as the scan result after scanning "EAN-13" barcode, one less.

You can select "EAN-13" type, enable "Check transmit Digit", and scan later the results show normal.

Example1: EAN-13 barcode: 6456813472345; When the "Check transmit Digit" is not enabled, the result shows 645681347234; and when the "Check transmit Digit" is enabled, the result shows 6456813472345.

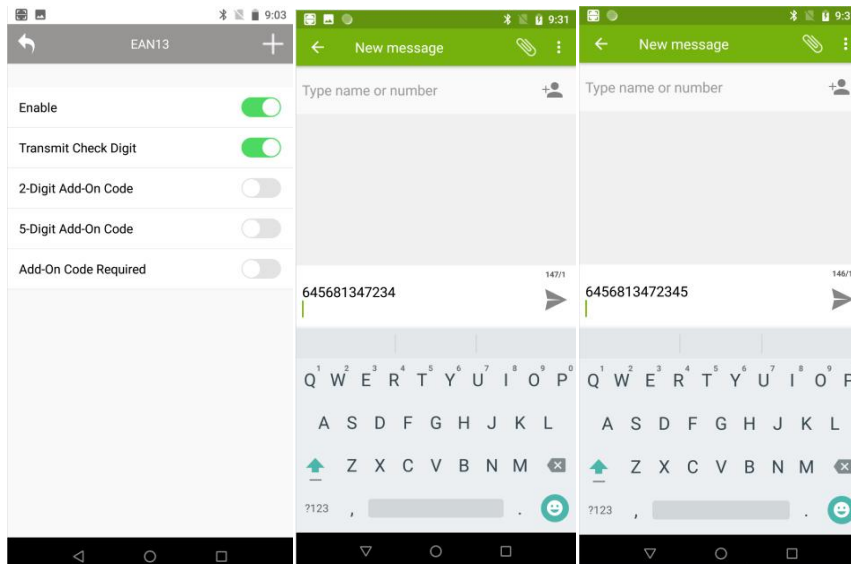

Choose code-1d-UPC-A-Enable

such as the scan result after scanning "UPC-A" barcode, one less.

You can select "UPC-A" type, enable "Check transmit Digit", and scan later the results show normal.

Example1: UPC-A barcode: 123456789012; When the "Check transmit Digit" is not

enabled, the result shows 12345678901, and when the "Check transmit Digit" is enabled, the result shows 123456789012.

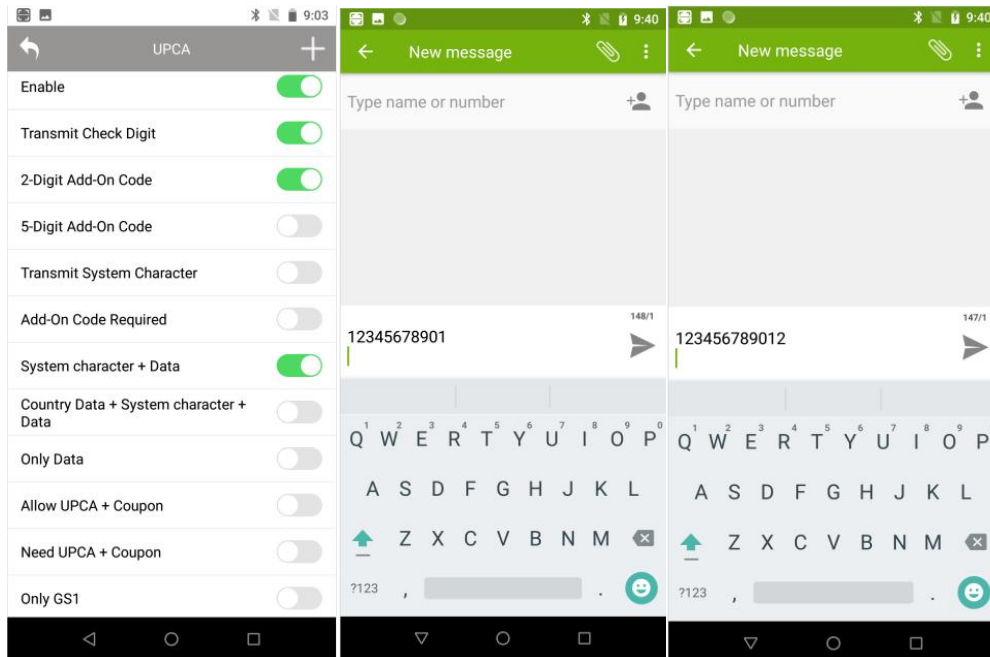

Choose code-1d-Code39-Enable

such as the scan result after scanning "Code39" barcode, one less.

You can select "Code39" type, enable "Transmit Start/Stop Characters", and scan later the results show normal.

Example1: Code39 barcode: ABCDEF; When the "Transmit Start/Stop Characters" is not enabled, the result shows *ABCDEF*, and when the "Transmit Start/Stop Characters" is enabled, the result shows ABCDEF.

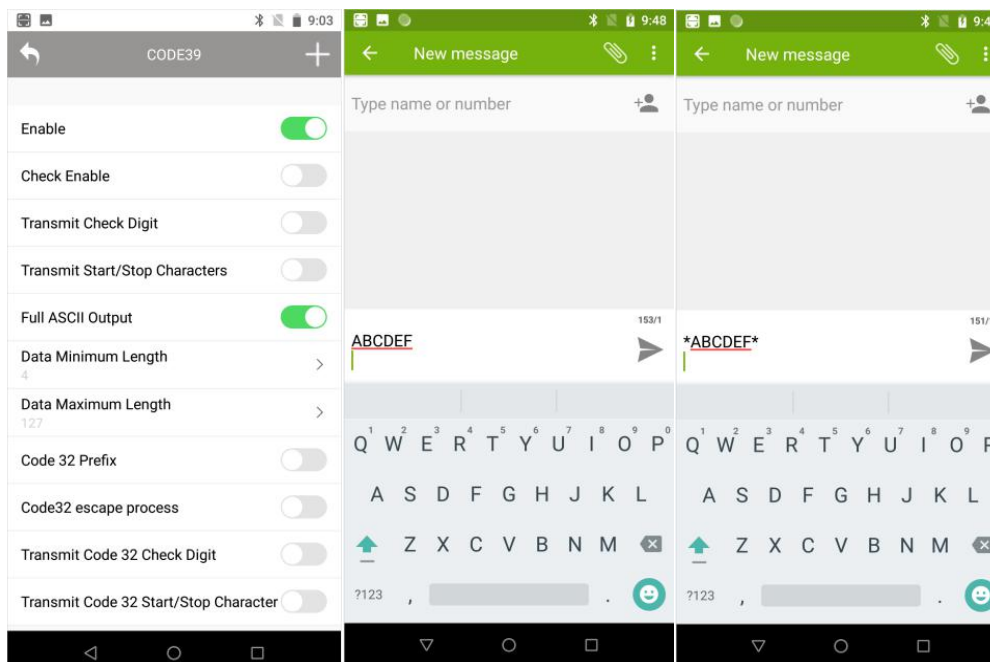

More settings

Click "Settings"->"Scan" to slide to the bottom, and click "More".

Check update:Show scan hand type.And can check update after connecting to the internet.

Note: "Check update"requires the scanning service version 5.1 or higher.

Custom broadcast:action:This is used to set a custom broadcast.

Custom broadcast barcode:key:This is used to set a custom broadcast content.

Custom broadcast type:key:This is used to set a custom broadcast type.

Analog keyboard output:Output analog keyboard.Cannot be used simultaneously with Output o cursor.

Overwrite last scan result:Delete thebarcode content of the original scan result and add the new barcode content of the scan result.

Center decoding:Decoding area:the center area after opening,the normal area after closing;That is ,when scanning dense barcode,the result of outputting barcode is at the center position of the laser.

Firmware update:Obtain and update scan head firmware after connecting to the internet.

Note:please use "Firmware Update" under the guidance of the manufacturer. Do not try it yourself.

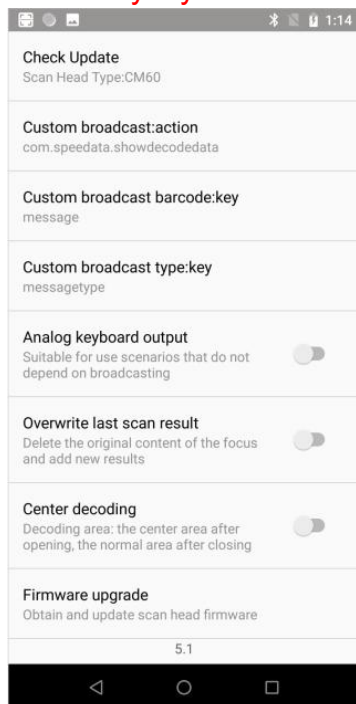

Physical key definition

Volume key	To adjust the volume.
Power key	Press to power on or power off.
Scan key	Press it to scan the barcode.
Home key	Press it to go to the home screen.
Resent key	View and switch tasks.
Screen off key	Turn off the display of the screen (Unlike the lock screen, the touch function is still available, and it can be scanned normally, but the screen backlight is turned off to save power.)
Back key	press it to go back to the previous screen.

Function keys:

F1~F4:Click settings->Key Remap,to configure physical keys.

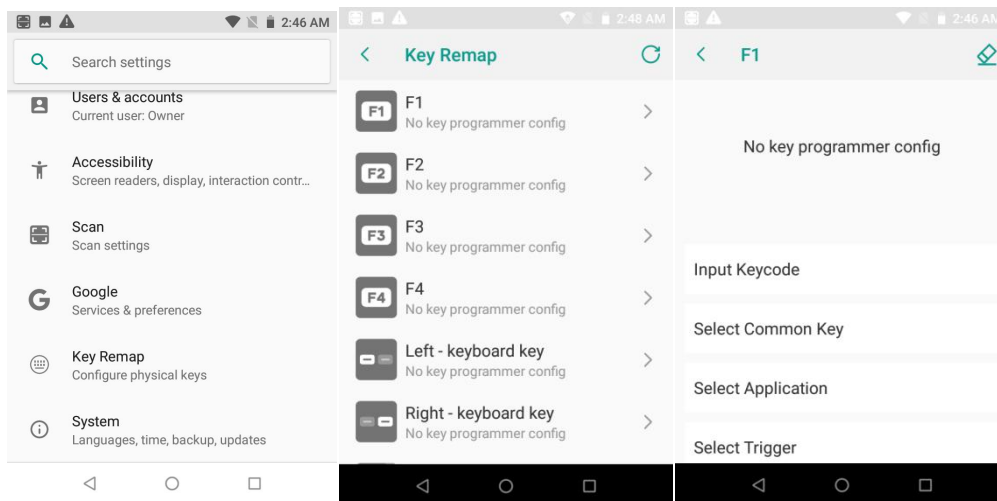

Input keycode:The keycode range is defined in the android keyevent,including letters,numbers,symbols,functions,etc.It can be used in scenarios where customers have special requirements for output symbols. For example, when using a keyboard-less device and without a keyboard, the customer wants to quickly delete the content of the text box, but does not want

to use the virtual keyboard. In the case of blind pressing, set the left side To delete the key, it can be customized as "67", which stands for "BackSpace", which can be used to quickly delete the physical keys.

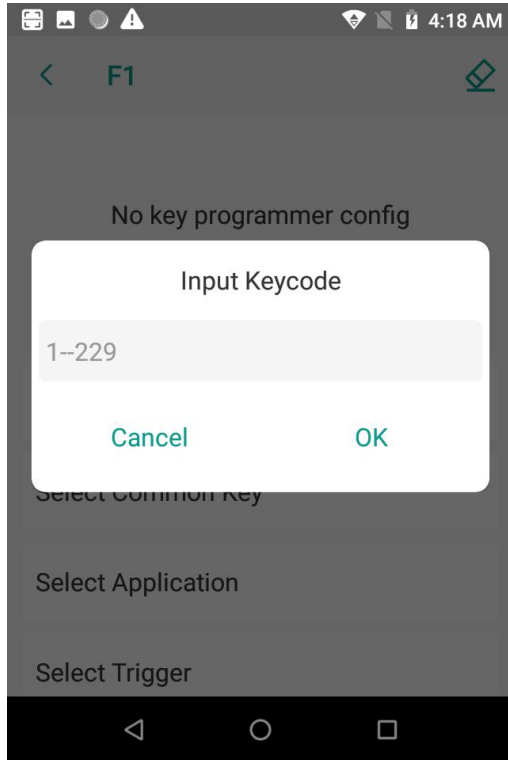

Select common key:For the convenience of the customers,some shortcut functions are listed separately.For example, HOME, SLEEP, WAKEUP, POWER, F1-F8, etc., quickly select without entering key values.

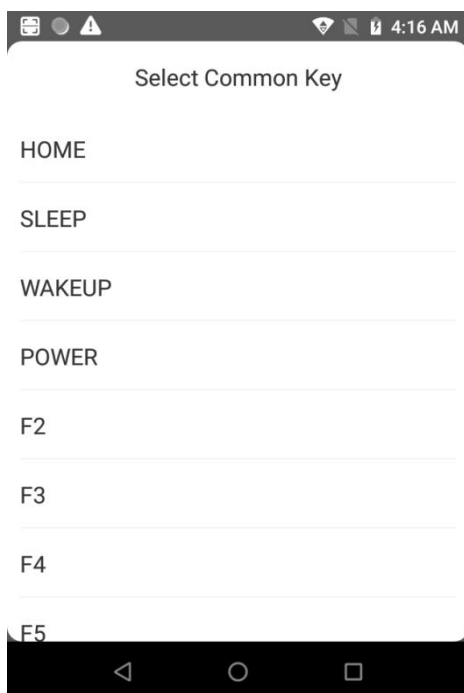

Select Application: Select application, you can quickly start an installed app on your device, including customer applications, system applications. By setting a key, selects the application that needs to be started, and start it with one key. After selecting, press the corresponding button to start the application. Currently, only short-press is supported, a long-press is not supported.

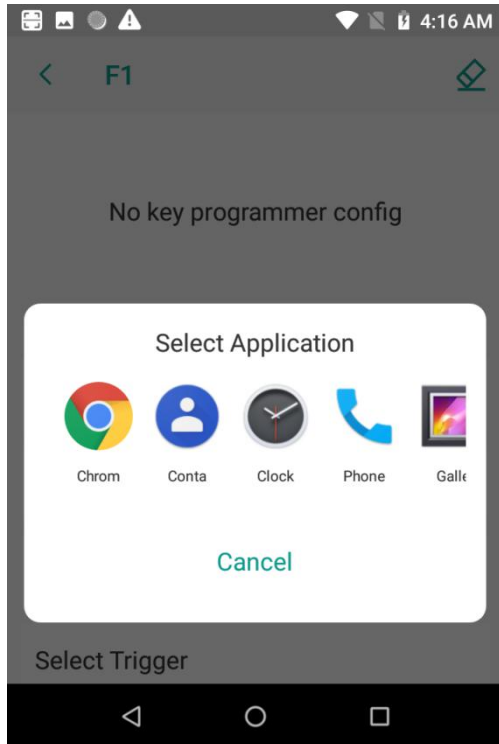

Select Trigger: Select trigger, which means to trigger the device's scan, UHF, temperature etc. Customers can set the function that the button needs to trigger. Such as triggering UHF on the left side, triggering scanning on the right side, and triggering UHF by the gun handle button.

Currently, it only supports pressing, and it will stop when released. The scanned device will only be triggered after it is turned on and needs to be selected. The default buttons are being optimized for the scanning function.

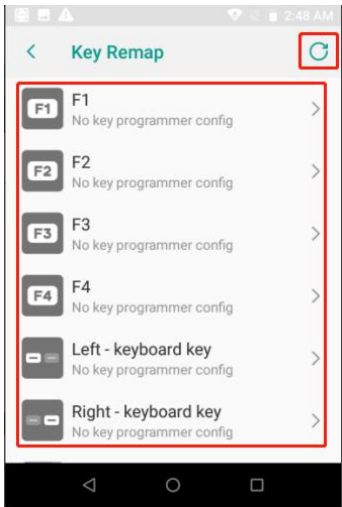
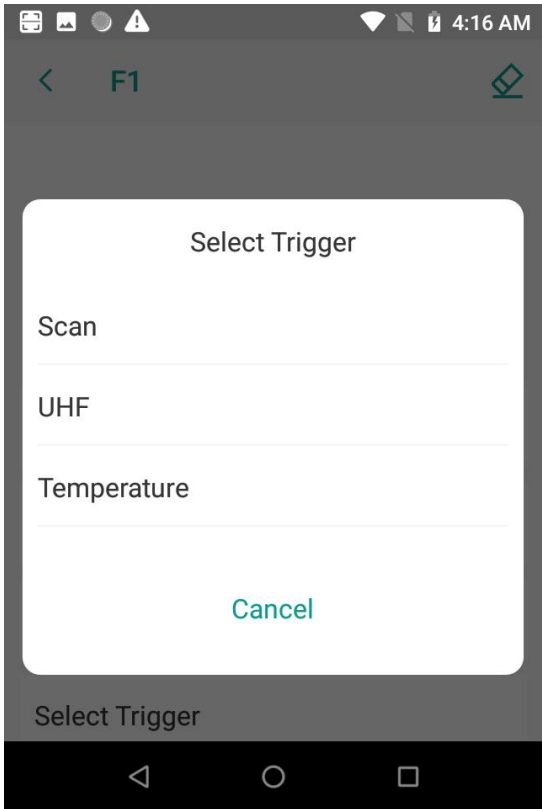

Restore all key settings

Entering the home page, you can view the the list of custom buttons that can be supported, and view the currently configured functions.

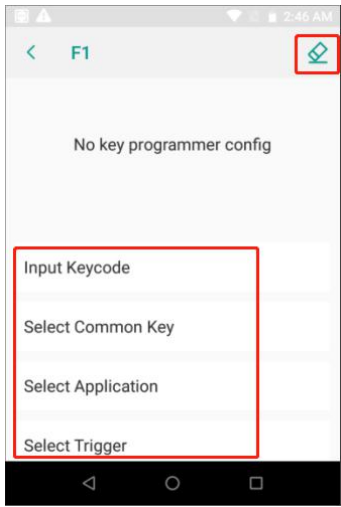

Restore the current key settings

Function list



Click settings->Key Remap,to configure physical keys.

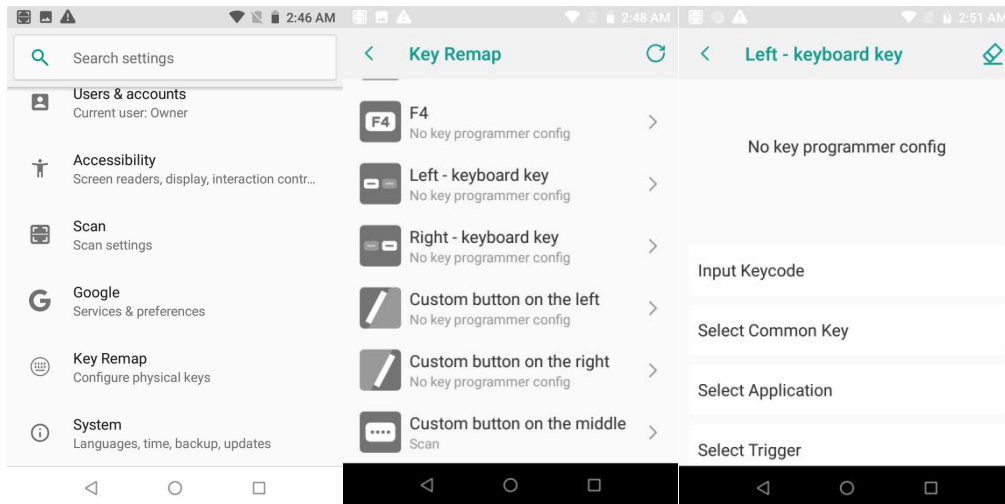

aA: Press it to switch between numbers and uppercase and lowercase by pressing the “aA” key.

Reset Options

Settings->System->Reset Options->Erace all data(factory reset)->reset phone

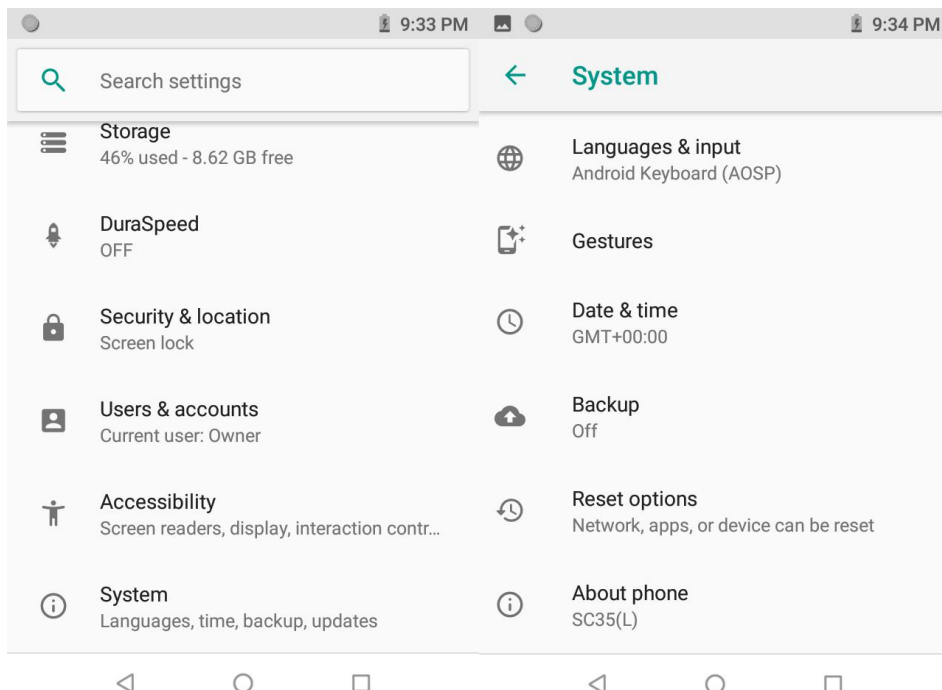

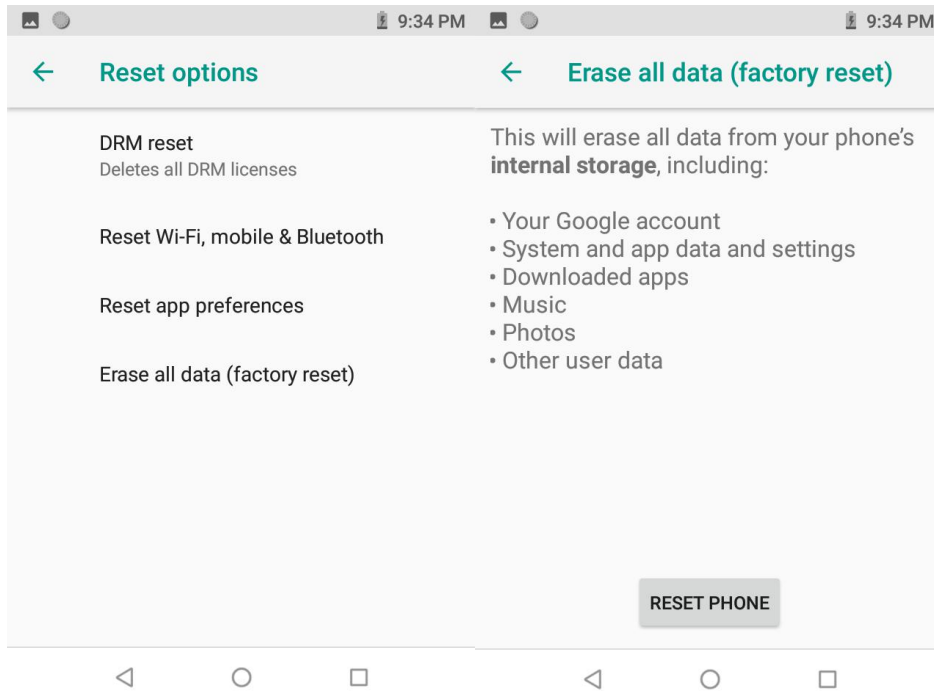

Development Support

For secondary development, please refer to the SDK support package attached with the document or contact us.

Product parameters

Size



Weight

About 290g (with battery)

(Note: Differences in different functional modules will cause actual weight differences, please refer to the actual product.)

IP Code

IP65

Color

Black

Screen

Size: 3.5 inches

Resolution: 640 * 960

Type: IPS

Touch screen: 5-point touch screen

Processor

CPU: Octa-core, 8*2.0 GHz

OS

Android 8.1

Memory

RAM: 2 GB

ROM: 16 GB

Micro SD: Extension max128GB

Battery

7000mAh (Typical value)

Charging: 2.0 fast charging, full no more than 4 hours

Camera

Rear camera: 1300MP, AF

Front camera: 500MP, FF

WWAN

Dual SIM dual standby single pass, support for Nano SIM card

FDD-LTE: B1/B3/B5/B7

TDD-LTE: B38/B39/B40/B41

TDSCDMA: B34/B39

WCDMA: B1/B2/B5/B8

GSM: B2/B3/B5/B8

CDMA: 1x/CDMA2000 BC0

Data connect

WI-FI: 802.11a/b/g/n, 2.4G & 5G

WI-FI hotspot: support

NFC: Support card reader mode, peer-to-peer mode, card emulation mode (14443A/B, ISO 15693, NFC)

Bluetooth: BT 4.0 (BLE)

USB: Type-C, OTG, USB tethering, USB fast charging

Location

GPS/GLONASS /Beidou

Barcode

Barcode engine model: CM60

Symbologies:

1D:

Code 128, EAN-13, EAN-8, Code 39, UPC-A, UPC-E, Codabar, ITF-6, ITF-14, ISBN, Code 93, UCC/EAN-128, Coop 2-of-5, etc.

2D:

PDF417、QR Code、Data Matrix、 etc.

Standard Range (SR) Optics	
Symbology/X-Dim	Typical Range*
EAN-13	65mm~330mm (13mil)
PDF 417	65mm~110mm (6.67mil)
Code 39	65mm~150mm (5mil)
Data Matrix	50mm~110mm (10mil)
QR Code	45mm~140mm (15mil)

Sensor

Gravity sensor

Light sensor

Gyroscope sensor

Geomagnetic sensor

Packing list

Standard:

SD35 (with battery) X 1

Power Adapter X 1

USB Type-C cable X 1

Instruction manual X 1



Newland EMEA HQ
+31 (0) 345 87 00 33
info@newland-id.com
newland-id.com

Need more info? Contact us or one of
our partners at newland-id.com/partners